



WET & DRY VACUUM CLEANER DOMUSIF-03 220-240/50-60 EU LAVOR

Content filters: validity 14/09/2017

14/09/2017

8.216.0502 - WET & DRY VACUUM CLEANER DOMUSIF-03 220-240/50-60 EU LAVOR.....	3
R82160502-2 - DOMUS IF-03 '03 WET&DRY 230/50EU LAVOR PRO.....	4
Components index.....	7

Pos.	Code	Description
0	R82160502-2	DOMUS IF-03 '03 WET&DRY 230/50EU LAVOR PRO

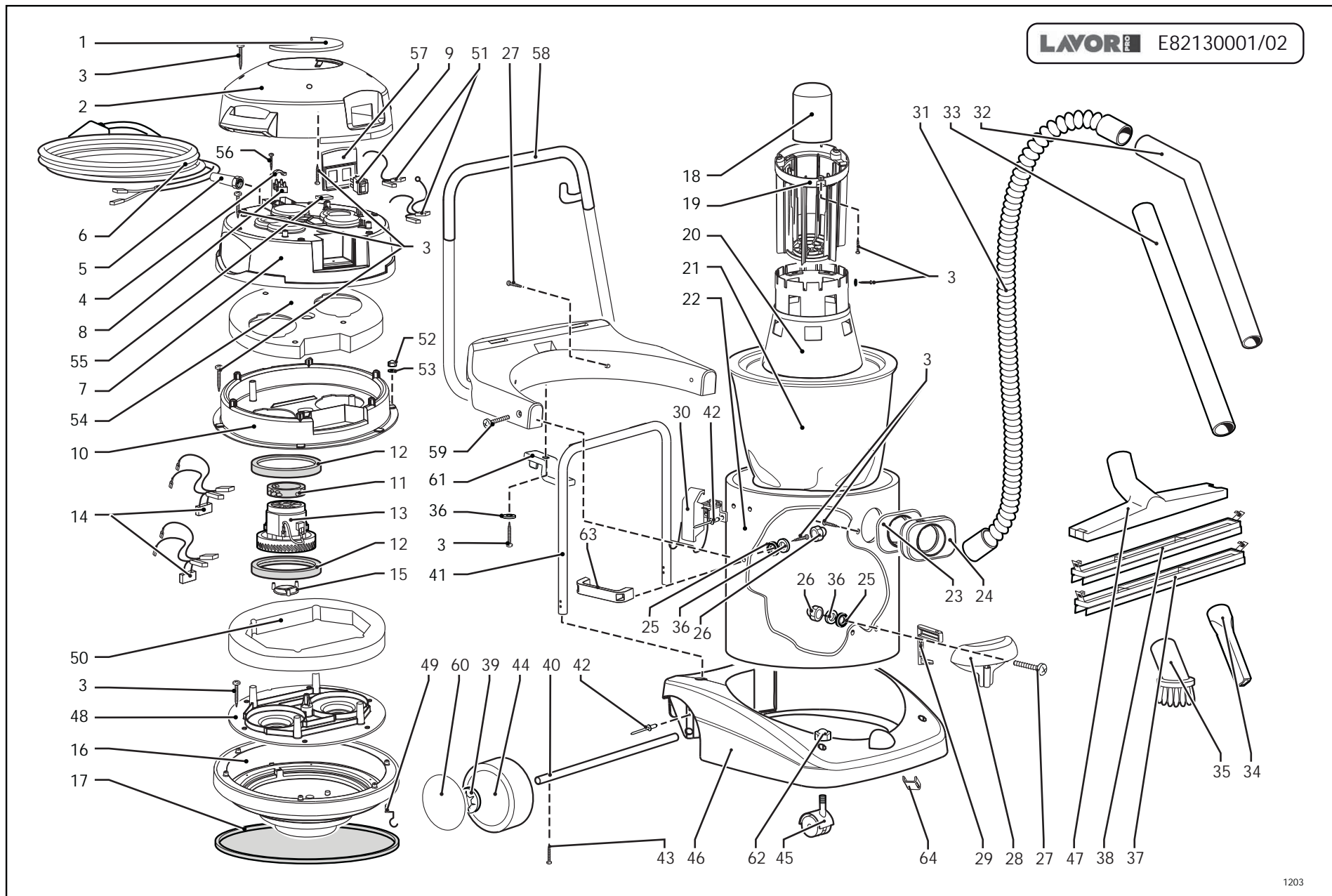

1203

Pos.	Code	Substituted by	Q.ty	Purchasable	Min. Q.ty	Price €	For mainten.	Description
001	4.208.0283		1	Yes	5	3.37		HANDLE FOR VACUUM CLEANER '03(DARK GREY RAL.7016)
002	4.208.0288		1	Yes	1	24.12		HEAD DOMUS-TAURUS '03 (DARK GREY RAL.7016)
003	3.002.0318		37	Yes	12	1.28		SCREW -TORX 5X16 D=10 ZNT BLACK
004	4.008.0277		1	Yes	12	1.28		FIX PAD CABLE HOLDER
005	3.406.0031		1	Yes	6	2.55		CABLE HOLDER 60X12X15.5 EPDM BLACK
006	4.012.0179		1	Yes	1	26.21		CABLE H05VV-F 2X1.5 MT.7 F/F SP.SCHUKO
007	4.208.0085	4.208.0400	1	Yes	1	24.12		UNDER COVER '03 2 MOTORS -G- RAL.1018
008	3.405.0055		1	Yes	2	11.83		JUNCTION-BOX 4MMQ. 110 12 380V
009	5.009.0213		2	Yes	3	5.25	EXT	SWITCH WITH PROTECTION 12(10)
010	4.208.0086		1	Yes	1	26.57		UPPER SPACER VACUUM CLEANER PROF.'03-2 MOTORS
011	3.299.0013		2	Yes	2	11.83		MOTOR GASKET 61X85
012	3.299.0014	3.299.0015	4	Yes	2	11.83		MOTOR GASKET 120X149
013	3.755.0069		2	Yes	1	56.39	EXT	UNIVERSAL MOTOR 230-240V-/50-60HZ
014	4.212.0003		2	Yes	3	5.92		CABLE 0.75 L=480
015	4.208.0095		2	Yes	2	8.16		VALVE DOMUS TAURUS
016	4.208.0293		1	Yes	1	24.12		MOTOR BASE x PROF.VACUUM CLEA.'03 (DARK GREY RAL.7016)
017	4.215.0013	6.205.0070	1	Yes	1	58.5		GASKET 410X445 EPDM 45 SH FORDOMUS - TAURUS
018	4.208.0096		1	Yes	3	5.25	EXT	FLOATING FOR DOMUS-TAURUS
019	4.208.0075		1	Yes	1	24.12		BASKET FOR PROFESSIONAL VACUUMCLEANER
020	4.208.0076		1	Yes	1	24.12		CONE
021	5.509.0039		1	Yes	1	23.65		FILTER
022	3.751.0016		1	Yes	1	87.21		INOX DRUM DOMUS/TAURUS
023	3.099.0455		1	Yes	6	2.81		GASKET
024	3.752.0075		1	Yes	2	8.52		COMPLETE HOSE CONNECTION D.40
025	4.215.0018		4	Yes	6	2.55		RUBBER WASHER 26X5X2
026	3.003.0047		6	Yes	12	1.28		NUT
030	3.099.0454		2	Yes	3	5	EXT	HOOK 2.05/621 ZNT FOR BODY TAURUS '03
031	5.209.0021		1	Yes	1	22.55	EXT	COMPLETE FLEXIBLE HOSE MT. 2.5D.40
032	3.753.0019		1	Yes	2	13.1		STEEL CURVED HOSE D. 38.2
033	3.753.0020		1	Yes	2	13.1		STEEL HOSE D. 38.2
034	3.754.0048		1	Yes	6	2.5		FLAT LANCE D.40

WET & DRY VACUUM CLEANER DOMUSIF-03 220-240/50-60 EU LAVOR - Content filters: validity 14/09/2017



R82160502-2 - DOMUS IF-03 '03 WET&DRY 230/50EU LAVOR PRO

Validity: from 17/09/2008 to 01/01/3000

14/09/2017

Page 5 / 7

Pos.	Code	Substituted by	Q.ty	Purchasable	Min. Q.ty	Price €	For mainten.	Description
035	3.754.0049		1	Yes	5	3.55		ROUND BRUSH D.40
036	3.004.0017		6	Yes	12	1.28		PLAIN WASHER D.5X10X1 UNI6592
037	3.754.0051	6.205.0121	1	Yes	1	25.4		BRISTLES
038	3.754.0052	6.205.0121	1	Yes	1	25.4		BLADES SQUEEGEE
039	3.099.0020		2	Yes	2	11.83		DIAM.150 WHEEL D.15 CLIP
040	4.207.0005		1	Yes	5	3.72		WHEELS AXLE FOR ZEUS-DOMUS-TAURUS D.15 L.490
041	4.207.0003		1	Yes	1	40.55		HANDLE FOR DOMUS-TAURUS'03 ECO
042	3.099.0453		4	Yes	12	1.28		ALLUM.PIN
043	3.002.0324		2	Yes	12	1.28		SCREW TC.-TC 5.5X32 ZNT
044	3.006.0057		2	Yes	2	11.83		WHEEL D. 175X48 HOLE 15 RIV.ANTI-TRACE COVERING
045	3.006.0058		2	Yes	2	11.83		WHEEL PIV. D.60 H82 M10x20 XECO VERSION (A122211TGN)
046	4.208.0287		1	Yes	1	45.08		DOMUS-TAURUS BASE'03 (DARK GREY) RAL 7016
047	3.754.0050	6.205.0121	1	Yes	1	25.4		HOLDER
048	4.208.0087		1	Yes	1	30.09		LOWER SPACER VACUUM CLEANER PROF.'03-2 MOTORS
049	5.213.0001		1	Yes	2	11.83		ANTISTATIC PLATE
050	4.215.0020		1	Yes	1	39.68		SPONGE HLC 24 AU SP.60 D.390MM2MOT
051	4.212.0001		1	Yes	3	5.92		WIRING SEZ.1,5 FOR VACUUM CLEANER PROF.
052	3.003.0001		1	Yes	12	1.28		NUT E. M4 MEDIO UNI 5588 CL8 ZNT
053	3.004.0003		1	Yes	12	1.28		WASHER D.4X8 DIN6798 ZNT
054	4.215.0097		1	Yes	2	11.83		SPONGE HLC 24 AU SP.60 D.340mm
055	4.408.0013		1	Yes	12	1.28		GASKET FOR QUICK CONNECTION SOCKET
056	3.002.0012		3	Yes	6	2.55		SELF-TAPPING SCREW 3,2X16
057	4.208.0069		1	Yes	6	2.55		SWITCH HOLDER '03 BLACK
060	3.099.0840		2	Yes	2	11.83		WHEEL COVER D.175 (GREY RAL 7016) (PANT.425C)
062	3.003.0048		2	Yes	6	2.55		NUT CL8 M10 CH. 15 ZNT
063	4.208.0132		2	Yes	6	2.65		HANDLE FOR DRUM (ZEUS-DOMUS- TAURUS).

WET & DRY VACUUM CLEANER DOMUSIF-03 220-240/50-60 EU LAVOR - Content filters: validity 14/09/2017

R82160502-2 - DOMUS IF-03 '03 WET&DRY 230/50EU LAVOR PRO

Validity: from 17/09/2008 to 01/01/3000

Code	Parts Table	Pos.	Q.ty
3.002.0012	R82160502-2	056	3
3.002.0318	R82160502-2	003	37
3.002.0324	R82160502-2	043	2
3.003.0001	R82160502-2	052	1
3.003.0047	R82160502-2	026	6
3.003.0048	R82160502-2	062	2
3.004.0003	R82160502-2	053	1
3.004.0017	R82160502-2	036	6
3.006.0057	R82160502-2	044	2
3.006.0058	R82160502-2	045	2
3.099.0020	R82160502-2	039	2
3.099.0453	R82160502-2	042	4
3.099.0454	R82160502-2	030	2
3.099.0455	R82160502-2	023	1
3.099.0840	R82160502-2	060	2
3.299.0013	R82160502-2	011	2
3.299.0014	R82160502-2	012	4
3.405.0055	R82160502-2	008	1
3.406.0031	R82160502-2	005	1
3.751.0016	R82160502-2	022	1
3.752.0075	R82160502-2	024	1
3.753.0019	R82160502-2	032	1
3.753.0020	R82160502-2	033	1
3.754.0048	R82160502-2	034	1
3.754.0049	R82160502-2	035	1
3.754.0050	R82160502-2	047	1
3.754.0051	R82160502-2	037	1
3.754.0052	R82160502-2	038	1
3.755.0069	R82160502-2	013	2
4.008.0277	R82160502-2	004	1
4.012.0179	R82160502-2	006	1

Code	Parts Table	Pos.	Q.ty
4.207.0003	R82160502-2	041	1
4.207.0005	R82160502-2	040	1
4.208.0069	R82160502-2	057	1
4.208.0075	R82160502-2	019	1
4.208.0076	R82160502-2	020	1
4.208.0085	R82160502-2	007	1
4.208.0086	R82160502-2	010	1
4.208.0087	R82160502-2	048	1
4.208.0095	R82160502-2	015	2
4.208.0096	R82160502-2	018	1
4.208.0132	R82160502-2	063	2
4.208.0283	R82160502-2	001	1
4.208.0287	R82160502-2	046	1
4.208.0288	R82160502-2	002	1
4.208.0293	R82160502-2	016	1
4.212.0001	R82160502-2	051	1
4.212.0003	R82160502-2	014	2
4.215.0013	R82160502-2	017	1
4.215.0018	R82160502-2	025	4
4.215.0020	R82160502-2	050	1
4.215.0097	R82160502-2	054	1
4.408.0013	R82160502-2	055	1
5.009.0213	R82160502-2	009	2
5.209.0021	R82160502-2	031	1
5.213.0001	R82160502-2	049	1
5.509.0039	R82160502-2	021	1